

December 22, 1989
1883H/hdm

Introduced by: LOIS NORTH

Proposed No. 90-132

9335

ORDINANCE NO. 9335

AN ORDINANCE relating to the annexation of an area known as 314R-S to Soos Creek Water and Sewer District for sewer service.

STATEMENT OF FACT:

1. A notice of intention proposing the annexation of an area known as 314R-S to Soos Creek Water and Sewer District for sewer service was filed with the county council effective December 22, 1989.
2. Soos Creek Water and Sewer District has found the petition for annexation to be sufficient and has, by Resolution No. 0436-S concurred with the proposed annexation.
3. Soos Creek Water and Sewer District filed a Declaration of Non-significant Impact dated November 14, 1989, on the proposed annexation.
4. The county council held a public hearing on the 5th day of February, 19 90 and has considered the criteria set forth in R.C.W. 56.02.060.

BE IT ORDAINED BY THE COUNCIL OF KING COUNTY:

SECTION 1. The annexation of Soos Creek Water and Sewer District of the area known as 314R-S for sewer service and described in Section 4 herein is approved. This proposed annexation is consistent with R.C.W. 56.02.060 as described in the attached King County Council Annexation Report on 314R-S.

SECTION 2. The Soos Creek Water and Sewer District is the appropriate entity to serve the area proposed to be annexed for sewer service.

1 SECTION 3. Completion of this annexation does not constitute
2 county approval or disapproval of any other permits, franchises,
3 certifications, or actions necessary to provide service to this
4 annexation area, nor does it authorize sewer service in any area
5 not designated as a "Local Service Area" by the King County
6 Sewerage General Plan.

7 SECTION 4. The area known as 314R-S to be annexed for sewer
8 service is described as follows:

9
10 Beginning at the Northwest corner of the Northeast quarter of
11 Section 26, Township 22 North, Range 5 East, W.M., King County,
Washington, said point being on the existing boundary of Soos
Creek Water and Sewer District;

12 Thence Easterly along the North line of said Section 26, also
13 being the centerline of S.E. 256th Street, to the West line of the
14 East half of the Northeast quarter of the Northeast quarter of the
Northeast quarter of said Section 26;

15 Thence Southerly along said West line to the South line of said
16 Northeast quarter of the Northeast quarter of the Northeast
quarter of said Section 26;

17 Thence Easterly along said South line to the East line of said
18 Section 26, also being the centerline of 164th Avenue S.E.;

19 Thence Southerly along said East line, to the East quarter corner
of said section 26;

20 Thence Southerly along the East line of the Southeast quarter of
21 said Section 26, to the South line of the North one-half of said
Southeast quarter of Section 26;

22 Thence Westerly along said South line to the West line of the East
23 one-half of the said North one-half of Southeast quarter of
Section 26;

24 Thence Northerly along said West line to the North line of said
25 Southeast quarter of Section 26;

26 Thence Westerly along said North line, also being the South line
27 of the Northeast quarter of said Section 26, to the West line of
the East one-half of the South one-half of the Southwest quarter
of said Northeast quarter of Section 26;

28 Thence Northerly along said West line to the North line of said
29 South one-half of Southwest quarter of Northeast quarter of
Section 26;

1 Thence Westerly along said North line to the West line of the
2 Northeast quarter of said Section 26;

3 Thence Northerly along said West line, also being the centerline
4 of 156th Avenue S.E., to the Northwest corner of the Northeast
quarter of said Section 26, being the Point of Beginning.

5 INTRODUCED AND READ for the first time this 16th day
6 of January, 1990.

7 PASSED this 26th day of February, 1990.

8 KING COUNTY COUNCIL
9 KING COUNTY, WASHINGTON

10 Lois North
11 Chairman

12 ATTEST:

13 Gerald A. Peterson
14 Deputy Clerk of the Council

15 APPROVED this 12th day of MARCH, 1990.

16
17 Russell Q.
18 King County Executive

SOOS CREEK WATER AND SEWER DISTRICT



SEWER SERVICE AREA

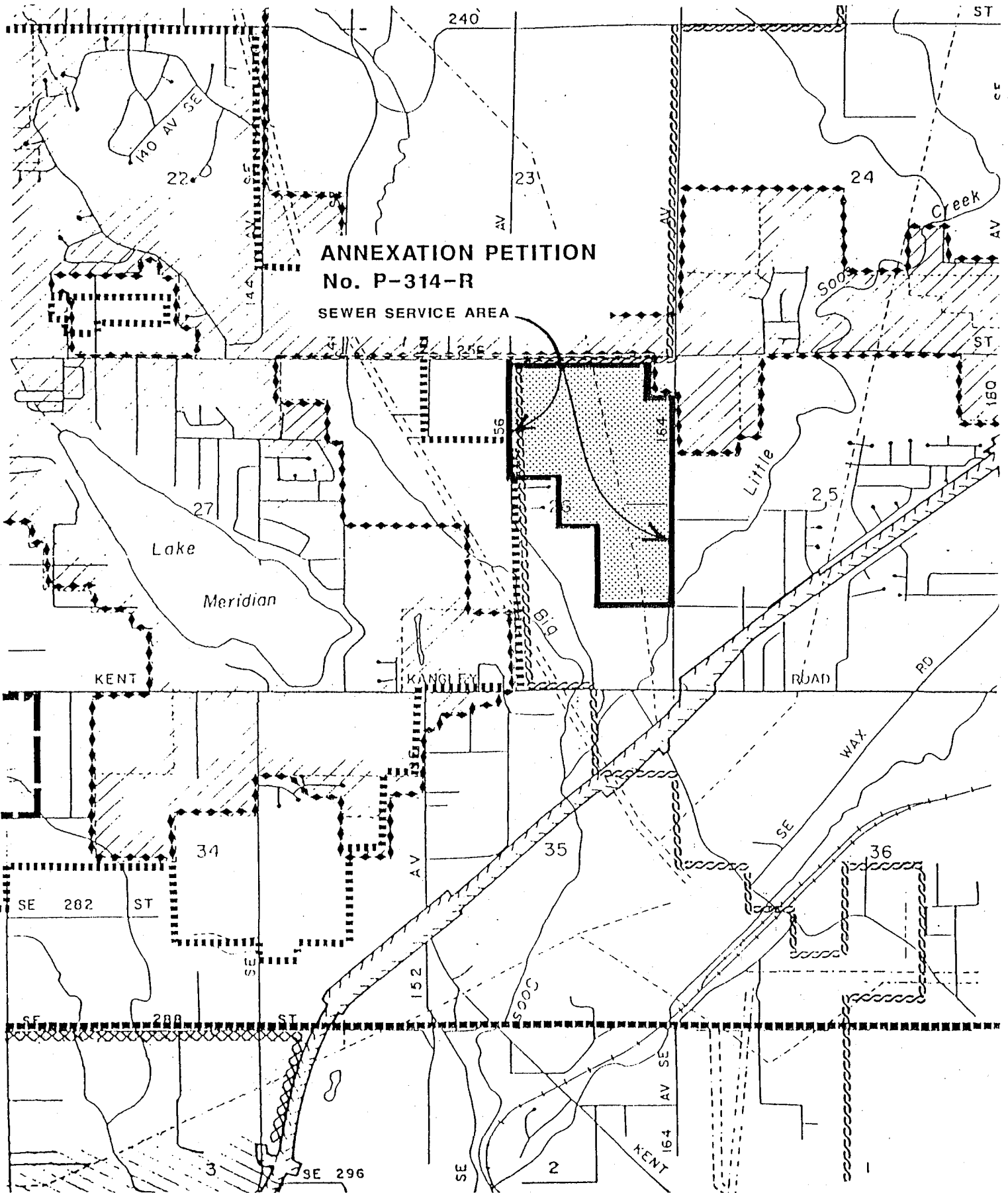

PROPOSED ANNEXATION

P-314-R

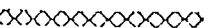

ANNEXATION PETITION
No. P-314-R
SEWER SERVICE AREA

- SOOS CREEK WATER & SEWER DISTRICT 
- SEWER SERVICE AREA ANNEXATION PETITION NO. P-314-R 
- MUNICIPALITY OF KENT SEWER SERVICE AREA 
- MUNICIPALITY OF AUBURN SEWER SERVICE AREA 

- WATER DISTRICT NO. 105 
- WATER DISTRICT NO. 111 
- FIRE DISTRICT NO. 37 
- ALL IN SCHOOL DISTRICT NO. 415 